

TRIANGLE TOWER

An Address to IMPRESS

RERA REGISGRATION NUMBER

UPRERAPRJ821807



TRIANGLETOWER.IN



"The stars are the apexes of what wonderful triangles!"

~ Henry David Thoreau

LUCKNOW

The New Emerging Smart Business City.

Why Lucknow?

the capital of Uttar Pradesh?

The state has the largest consumer base in the country of more than 200 million people. The per capita income is increasing steadily in state, giving rise to one of the biggest markets for industrial houses.

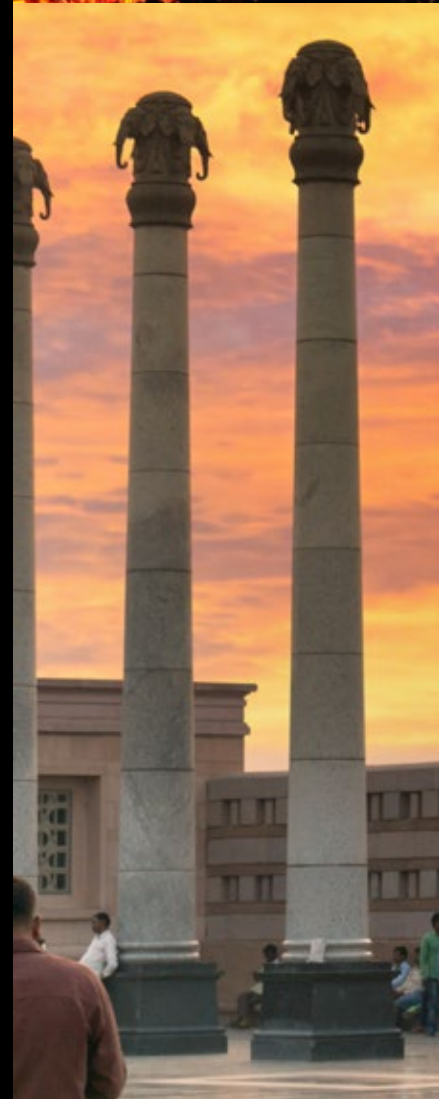





Why a triangular Tower

Everything in life symbolizes something and speaks for itself even shapes.

A Triangle represents success because it elevates and leads our eye to a certain point, which is to the top, it pushes our limits to overcome challenges. Structure of mountains & mathematical delta are triangular, these are metaphors for pushing yourself for becoming the best, physically, mentally, and socially.



100a



tion

Areas of Interest

1

Ram Manohar Lohia Super Speciality Hospital

Ram Manohar Lohia Hospital, which is a super specialty medical institute having facilities for over 1500 students of PG medical education, research and front line patient care.

**Distance from Triangle
Tower: 0 Mtr.**

2

Lucknow High Court

High court in Vibhuti Khand, Lucknow is one the biggest high court in India.

**Distance from Triangle
Tower: 200 mtr.**

3

Indira Gandhi Pratishthan

situated in Gomti Nagar, Lucknow, which is a perfect venue for all types of events & trade shows.

**Distance from Triangle
Tower: 200 Mtr.**

4

Gomti Nagar Railway Station

World class railway terminus in Gomti Nagar to start by 2022.

**Distance from Triangle
Tower: 1 Km.**



**The greatness of
art is not to find
what is common
but what is
unique.**



TRIANGLE TOWER

An Address to IMPRESS





1.



2.



3.



4.

Salient Features

- Cutting edge architectural design, State of the art facility management system.
- Efficient design maximising carpet area of spaces.
- Maximised hybrid security system.
- Parking assistant.
- Power Backup.
- Vastu Compliant.
- Superior specifications in common areas with granite floors.
- Energy efficient & Smart sensors for lighting & Power backup.
- Ample two and four wheeler covered parking spaces with use of mechanised car parking system.
- Pollution free basement.
- High Speed Elevators.
- Ramp Access to the Basement.





Dropoff & Private
Underground Parking

11

Shops at Lower Basement

— Total Plate Area	4042 Sq. Ft
— Carpet Area	1815 Sq. Ft.
— Super Area	2227 Sq. Ft

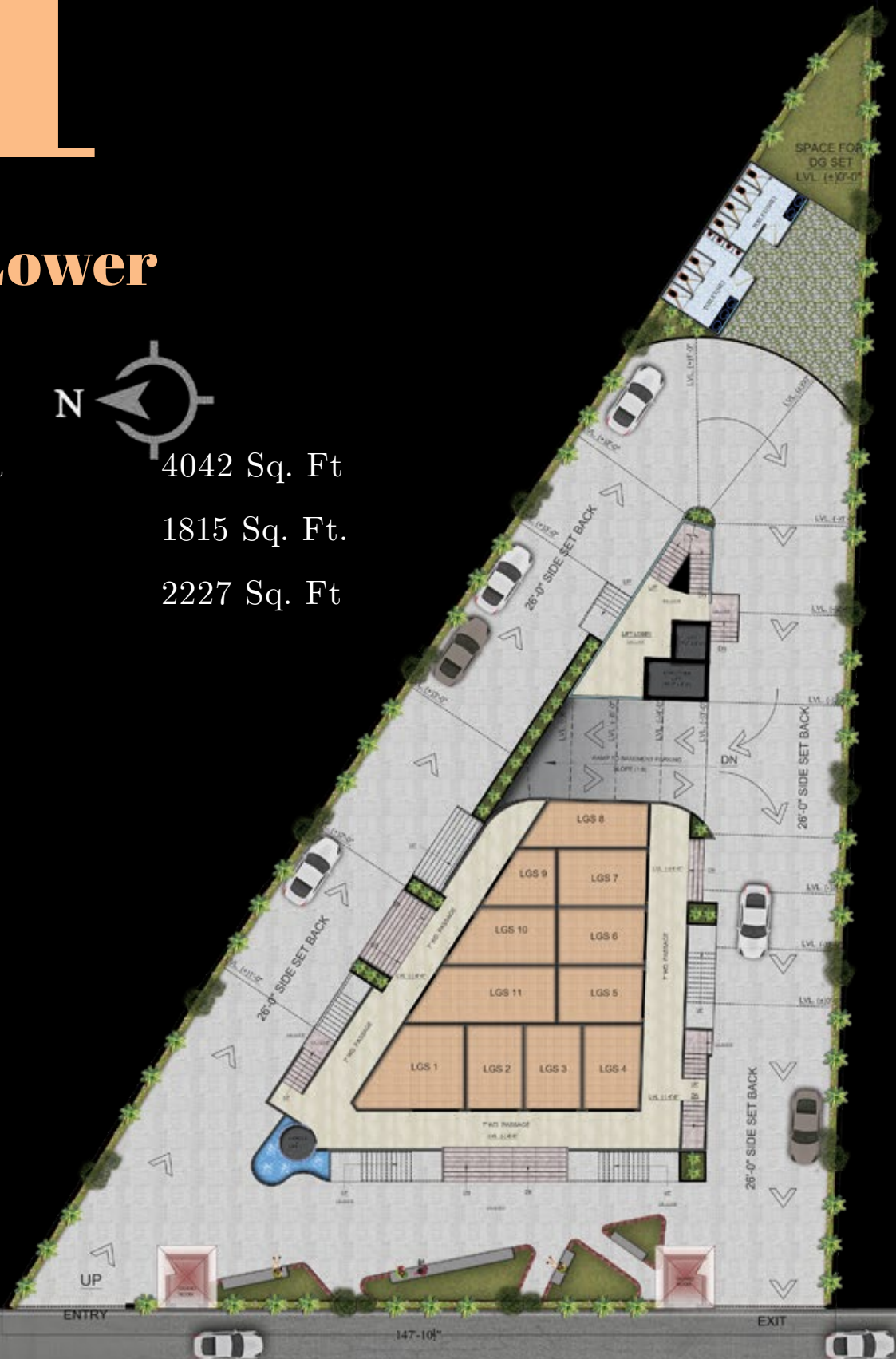

12

Shops at Upper Ground Floor



- Shops with Mezzanine (UGMS) 8
- Total Plate Area 5049.5 Sq. Ft.
- Carpet Area 3043.2 Sq. Ft.
- Super Area 2006.3 Sq. Ft.

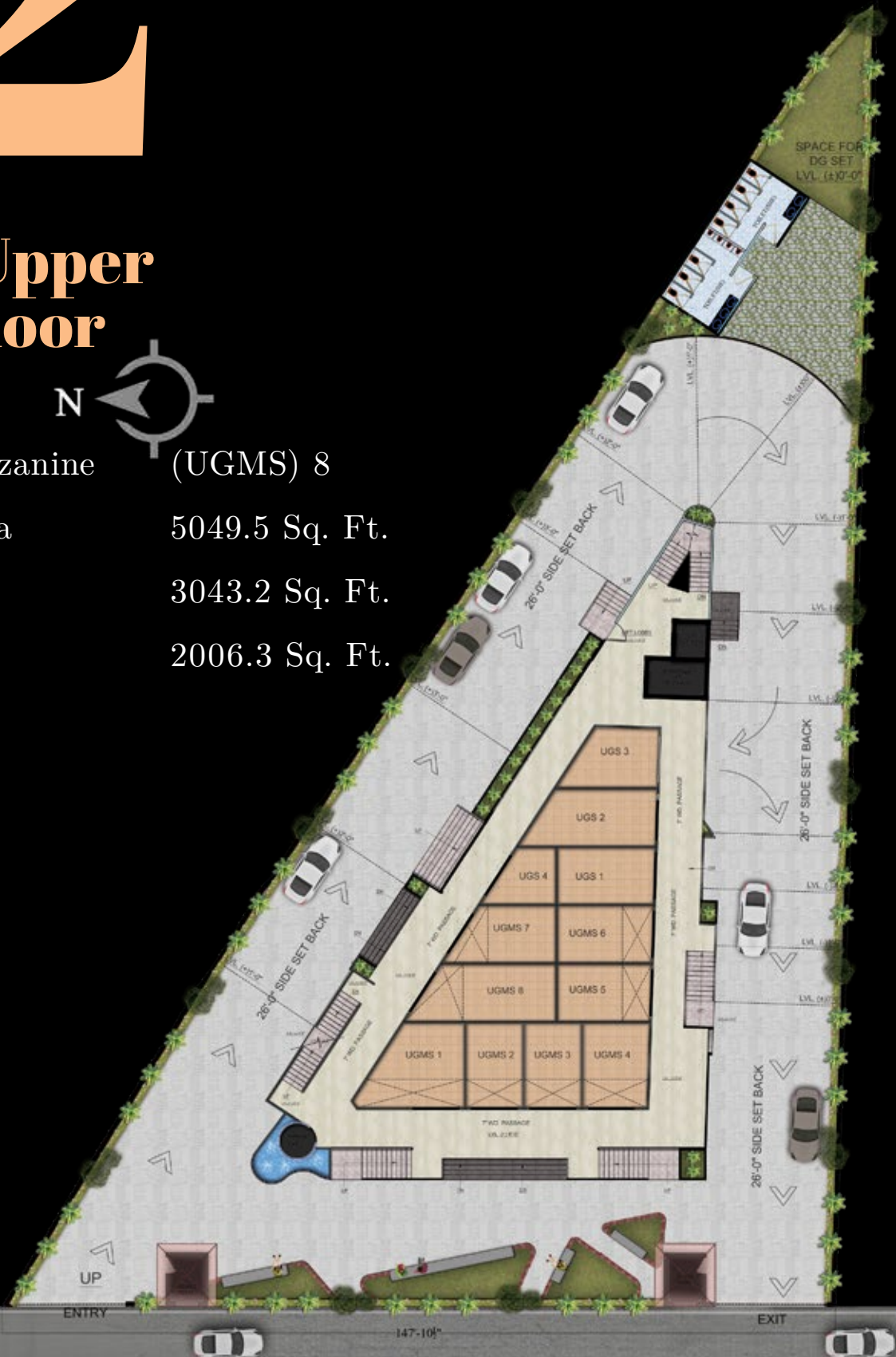

4

Shops at Mezzanine Floor

- Total Plate Area 1844.5 Sq. Ft
- Carpet Area 636.6 Sq. Ft.
- Super Area 1207.9 Sq. Ft

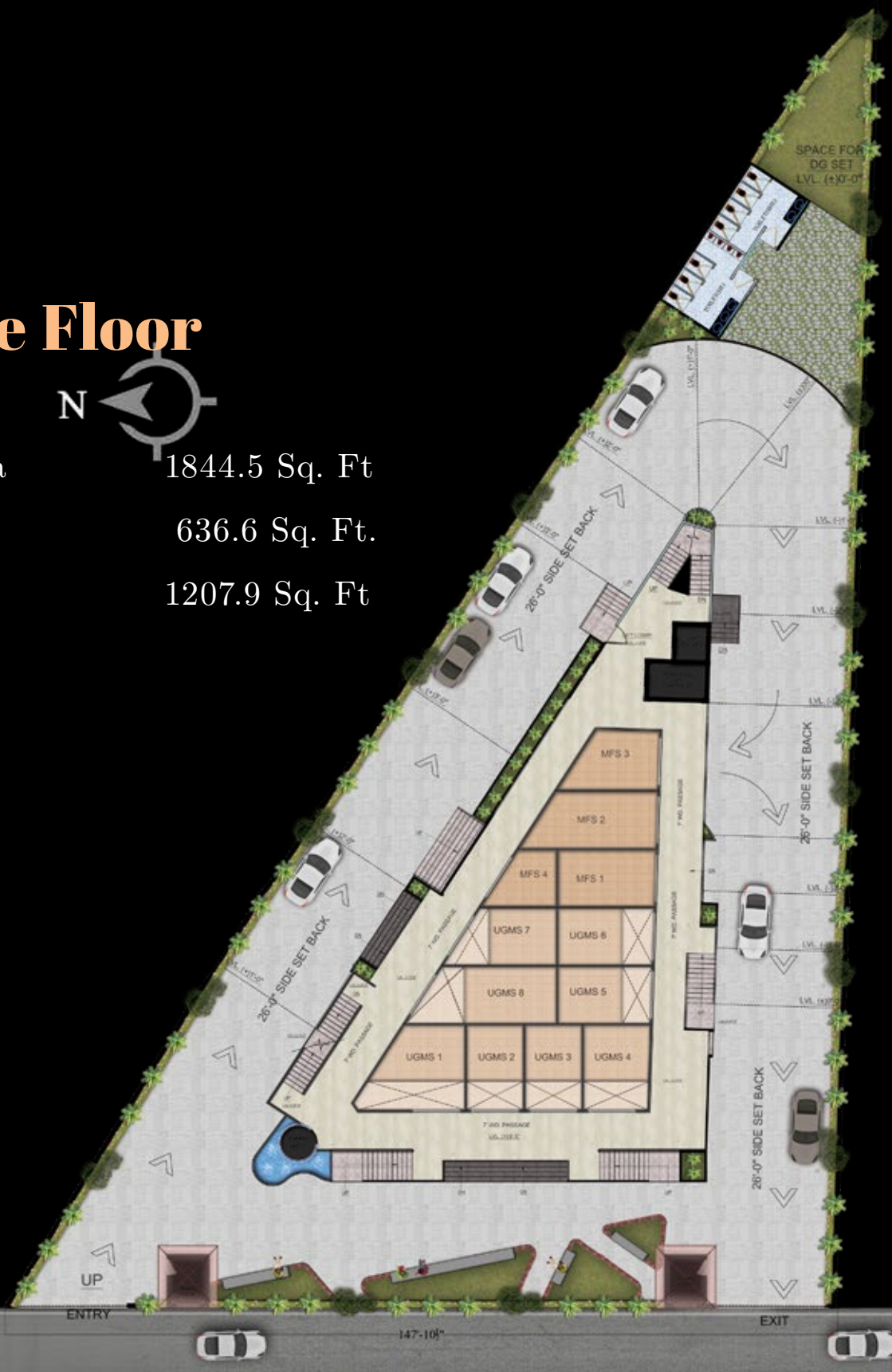

12

Shops at First Floor

- Total Plate Area 4538.87 Sq. Ft
- Carpet Area 2078 Sq. Ft.
- Super Area 2460.87 Sq. Ft

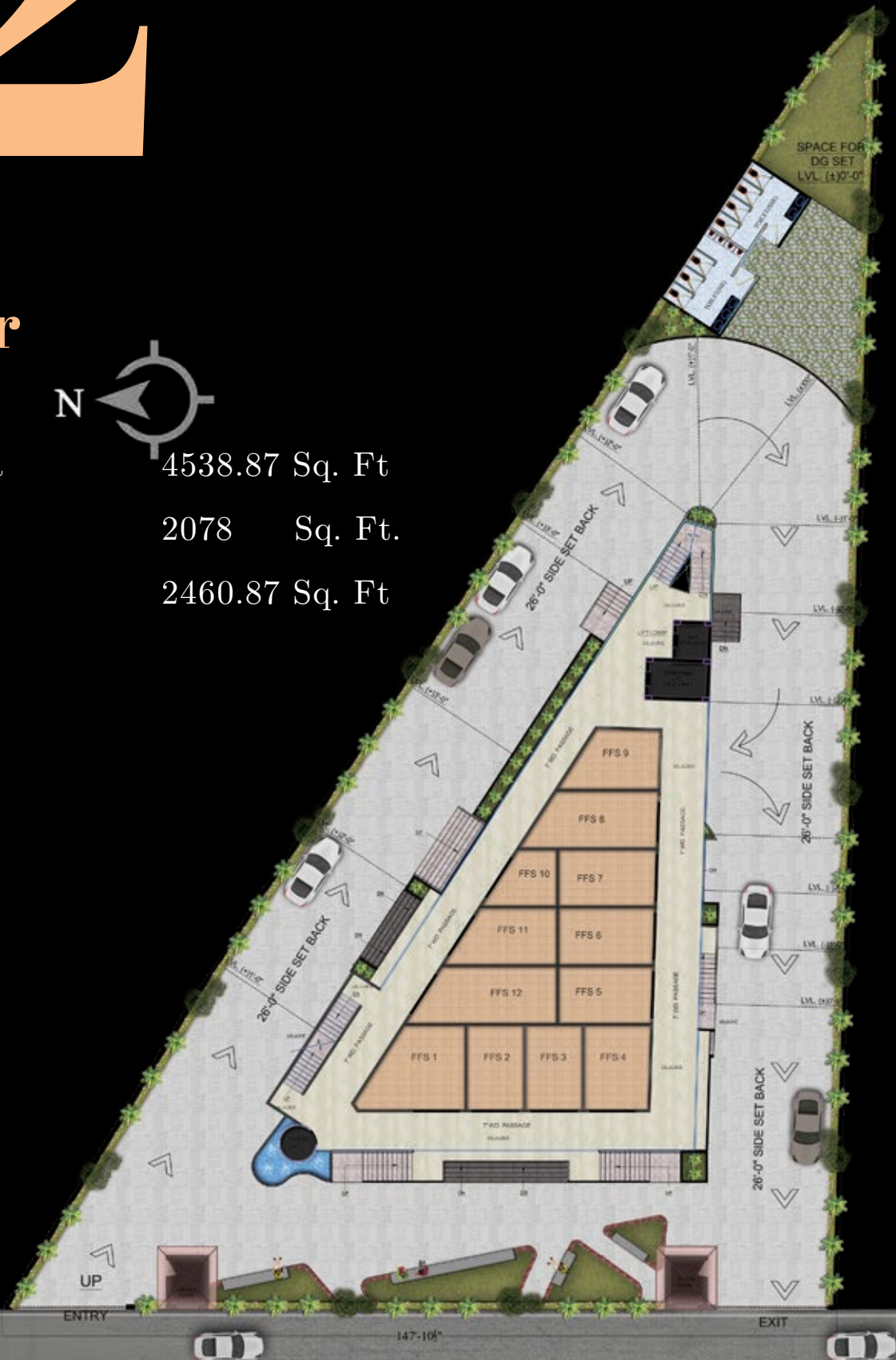



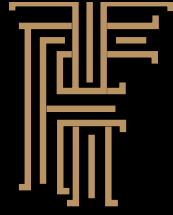

TRUEFRIEND

TRUEFRIEND AGRO PVT. LTD.

UPRERAPRM135411

TRUEFRIEND INFRAMART PVT. LTD.

UPRERAPRM135639

SALES OFFICE

DLF MYPAD, 9th Floor, B2/925,
Vibhuti Khand, Gomti Nagar, Lucknow, Uttar Pradesh - 10.

SITE ADDRESS

TC 46 VIII, Adjacent Ram Manohar Lohia Hospital,
Vibhuti Khand, Gomti Nagar, Lucknow, Uttar Pradesh - 10.

Sales Enquiry Call us:

1800 1022 381

info@triangletower.in | www.triangletower.in



TRIANGLETOWER.IN