



Get ready to embrace luxury

OMEGA  
**Windsor Greens**  
Premium Living. Green Environs.

---

RERA REGN NO.: **UPRERAPRJ17311**

---



Get ready to embrace luxury



Windsor Greens  
Premium Living. Green Environs.





Before the four walls of a home comes the location of a home. And Omega Windsor Greens boasts of a location second to none in the numerous projects cropping up in the whole of Lucknow. Located in the prime location of Main Faizabad Road, Windsor Greens is within kissing.

## Locales that complement the luxurious lifestyle

Just few minutes drive from main city, the project is close to all necessities.





Yet another high rise living destination surfaces on the horizon. But this one is not just a high rise. It is a luxurious high rise project.

## Step into a world of sheer splendour

The ingredients that comprise the whole project, like flat specification, amenities, club, security, and landscaping are premium class. As for homes, well they are spacious, airy and designed for optimum privacy. Just like home should be.

**OMEGA**  
**Windsor Greens**  
Premium Living. Green Environs.



Omega Windsor Greens is a group housing project being developed by M/s Omega Developers and Builders. Windsor Greens, located on Faizabad main road, is a luxurious residential project. It brings with it all that you ever wanted, to connect with the things that you cherish. Beginning with your loved ones. All thanks to the perfect location the project boasts of that makes sure you are always closer to home.

Occupying 7.50 acres on the burgeoning Faizabad area, it comprises of 10 towers and scaling up to Basement + G + 14 floors. Windsor Greens offers 2BHK & 3BHK exclusive homes. Add to it the top class amenities the apartment comes loaded with and you have a home that lets you enjoy quality time with your family and also some me-time with yourself.

In Phase 1, Two 3 BHK Towers and One 2 BHK Towers will be constructed, that is, Towers A-1, A-2 and D-1 will be constructed. In future phases others towers will be constructed.





### *Apartment Features*

- Double height entrance lobby in each tower
- Very wide balconies in each apartment
- Every room is attached with a balcony
- All rooms well ventilated

## Savour the comforts awaiting you

- Intercom in each apartment
- CCTV cameras on each floor and lobby.
- 2 High speed elevators for each apartment tower
- 100% power backup for complete essential service





### High End Club

- Indoor 15 - 20 seater movie theatre
- Single Track Bowling alley
- Cards room
- Kids play room
- Cafeteria/Restaurant
- Gym
- Aerobics room
- Swimming pool
- Banquet with attached kitchen

## Spoil yourself in the sinful rejuvenation

### Indoor Activities

- Billiards
- Table Tennis
- Card Room
- Badminton Court

### Outdoor Activities

- Cycling & Jogging Tracks
- Skating Rink
- Outdoor Gym
- Yoga Court
- Kids Slides and Swings



# Indoor Activities



BILLIARDS



TABLE TENNIS



CARD ROOM



BADMINTON COURT

# Outdoor Activities



JOGGING TRACK



CYCLING TRACK



SKATING RINK



- Mesmeric entrance plaza
- Numerous Landscaped Parks
- Senior Citizen Plaza

## Features of project

- Reflexology Park
- Outdoor Gym
- Flower Garden
- Kids Play Area





# The ideal place for your Dream Home



## Distance from Omega Windsor Greens

- Gomti Nagar Railway Station - 9.5 Kms
- Hazratganj - 15 Kms
- Polytechnic - 8 Kms

- New High Court - 7 Kms
- Matiyari Chauraha - 3.7 Kms

Omega Windsor Greens Site Plan





# Floor Plan

## Tower A1 & A2 Ground Floor

2 & 3

CARPET AREA :  
98.56 SQ.MT. / 1060.90 SQ.FT.

SUPER AREA :  
149.57 SQ.MT. / 1610 SQ.FT.

1 & 4

CARPET AREA :  
82.48 SQ.MT. / 887.81 SQ.FT.

SUPER AREA :  
125.42 SQ.MT. / 1350 SQ.FT.



# Floor Plan

## Tower A1 & A2 First Floor

2 & 3

CARPET AREA :  
98.56 SQ.MT. / 1060.90 SQ.FT.

SUPER AREA :  
149.57 SQ.MT. / 1610 SQ.FT.

1 & 4

CARPET AREA :  
100.67 SQ.MT. / 1083.61 SQ.FT.

SUPER AREA :  
152.42 SQ.MT. / 1640 SQ.FT.



Floor Plan

Tower A1 & A2  
Second Floor

2 & 3

CARPET AREA :  
98.56 SQ.MT. / 1060.90 SQ.FT.

SUPER AREA :  
149.57 SQ.MT. / 1610 SQ.FT.

1 & 4

CARPET AREA :  
82.48 SQ.MT. / 887.81 SQ.FT.

SUPER AREA :  
152.42 SQ.MT. / 1640 SQ.FT.

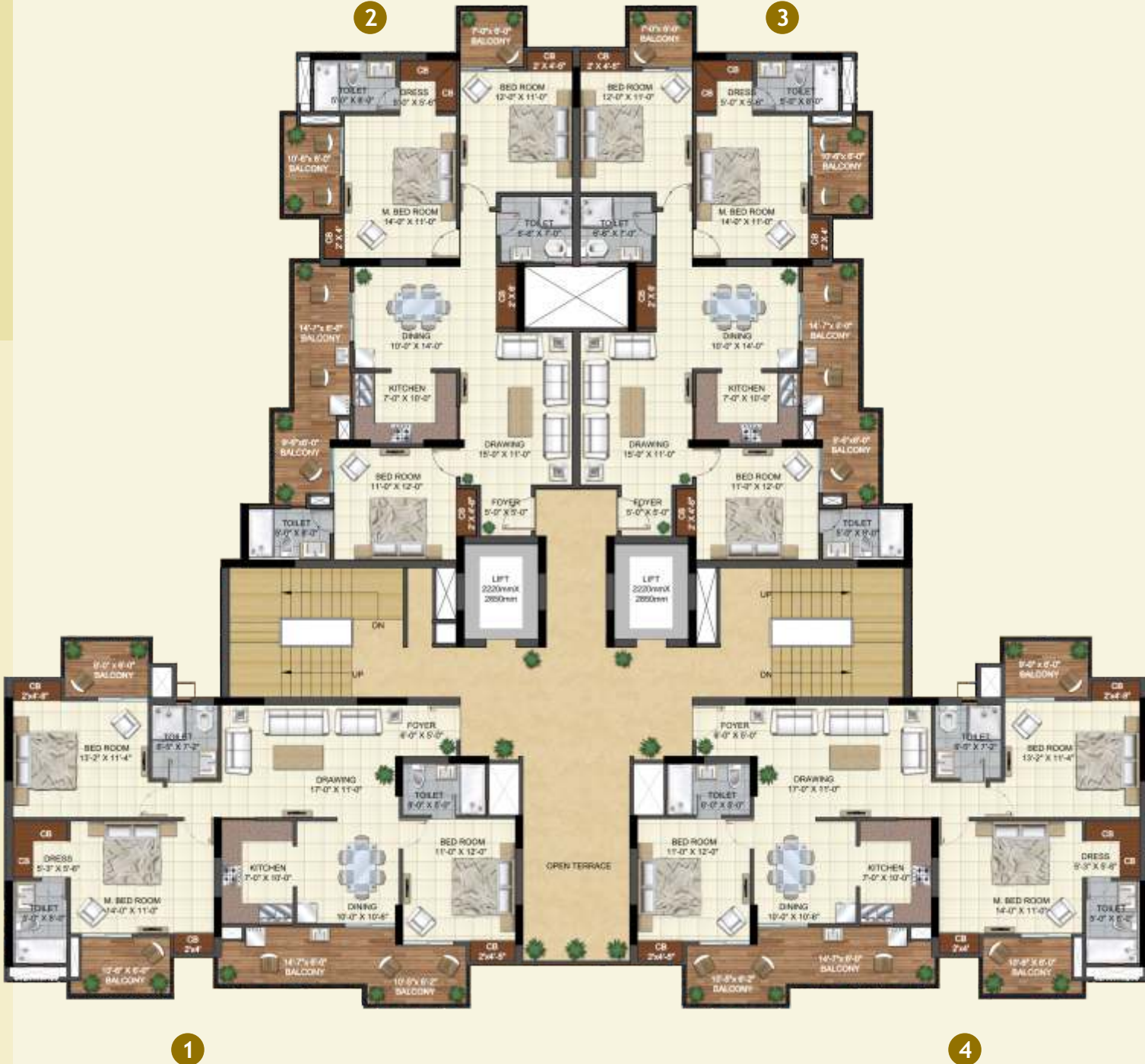

Floor Plan

Tower A1 & A2  
3rd to 13th Floor

2 & 3

CARPET AREA :  
98.56 SQ.MT. / 1060.90 SQ.FT.

SUPER AREA :  
149.57 SQ.MT. / 1610 SQ.FT.

1 & 4

CARPET AREA :  
100.67 SQ.MT. / 1083.61 SQ.FT.

SUPER AREA :  
152.42 SQ.MT. / 1640 SQ.FT.



Floor Plan

Tower A1 & A2  
14th Floor

2 & 3

CARPET AREA :  
84.09 SQ.MT. / 905.14 SQ.FT.

SUPER AREA :  
129.13 SQ.MT. / 1390 SQ.FT.

1 & 4

CARPET AREA :  
85.58 SQ.MT. / 921.18 SQ.FT.

SUPER AREA :  
131.92 SQ.MT. / 1420 SQ.FT.



Unit Plan

Tower A1 & A2  
3BHK  
1640 SQ.FT.

CARPET AREA :  
100.67 SQ.MT. / 1083.61 SQ.FT.

BALCONY AREA :  
24.04 SQ.MT. / 258.77 SQ.FT.

COVERED AREA :  
120.50 SQ.MT. / 1297.06 SQ.FT.

SUPER AREA :  
152.36 SQ.MT. / 1640 SQ.FT.



Unit Plan

Tower A1 & A2  
3BHK  
1610 SQ.FT.

- CARPET AREA :  
98.56 SQ.MT. / 1060.90 SQ.FT.
- BALCONY AREA :  
22.15 SQ.MT. / 238.42 SQ.FT.
- COVERED AREA :  
117.54 SQ.MT. / 1265.20 SQ.FT.
- SUPER AREA :  
149.57 SQ.MT. / 1610 SQ.FT.



Unit Plan

Tower A1 & A2  
2BHK + STUDY  
1529 SQ.FT.

- CARPET AREA :  
86.22 SQ.MT. / 928.07 SQ.FT.
- BALCONY AREA :  
18.54 SQ.MT. / 199.56 SQ.FT.
- TERRACE AREA :  
20.24 SQ.MT. / 217.86 SQ.FT.
- COVERED AREA :  
104.49 SQ.MT. / 1124.73 SQ.FT.
- SUPER AREA :  
(INCLUDING 50% TERRACE AREA)  
142.10 SQ.MT. / 1529 SQ.FT.



Unit Plan

Tower A1 & A2  
2BHK + STUDY  
1499 SQ.FT.

- CARPET AREA :  
84.09 SQ.MT. / 905.14 SQ.FT.
- BALCONY AREA :  
17.04 SQ.MT. / 183.42 SQ.FT.
- TERRACE AREA :  
20.24 SQ.MT. / 217.86 SQ.FT.
- COVERED AREA :  
101.52 SQ.MT. / 1092.76 SQ.FT.
- SUPER AREA :  
(INCLUDING 50% TERRACE AREA)  
139.31 SQ.MT. / 1499 SQ.FT.



Unit Plan

Tower A1 & A2  
2BHK  
1350 SQ.FT.

- CARPET AREA :  
82.48 SQ.MT. / 887.81 SQ.FT.
- BALCONY AREA :  
18.61 SQ.MT. / 200.31 SQ.FT.
- COVERED AREA :  
98.99 SQ.MT. / 1065.53 SQ.FT.
- SUPER AREA :  
125.42 SQ.MT. / 1350 SQ.FT.



# Floor Plan

## Tower D1 Ground Floor

2 & 3

CARPET AREA :  
75.31 SQ.MT. / 810.64 SQ.FT.

SUPER AREA :  
117.05 SQ.MT. / 1260 SQ.FT.

1 4 5 & 6

CARPET AREA :  
67.35 SQ.MT. / 724.95 SQ.FT.

SUPER AREA :  
111.02 SQ.MT. / 1195 SQ.FT.



# Floor Plan

## Tower D1 First Floor

2 & 3

CARPET AREA :  
75.31 SQ.MT. / 810.64 SQ.FT.

SUPER AREA :  
117.05 SQ.MT. / 1260 SQ.FT.

1 4 5 & 6

CARPET AREA :  
67.35 SQ.MT. / 724.95 SQ.FT.

SUPER AREA :  
111.02 SQ.MT. / 1195 SQ.FT.



# Floor Plan

## Tower D1 Second Floor

2 & 3

CARPET AREA :  
75.31 SQ.MT. / 810.64 SQ.FT.

SUPER AREA :  
117.05 SQ.MT. / 1260 SQ.FT.

1 4 5 6 & 7

CARPET AREA :  
67.35 SQ.MT. / 724.95 SQ.FT.

SUPER AREA :  
111.02 SQ.MT. / 1195 SQ.FT.



# Floor Plan

## Tower D1 3rd to 14th Floor

2 & 3

CARPET AREA :  
75.31 SQ.MT. / 810.64 SQ.FT.

SUPER AREA :  
117.05 SQ.MT. / 1260 SQ.FT.

1 4 5 6 & 7

CARPET AREA :  
67.35 SQ.MT. / 724.95 SQ.FT.

SUPER AREA :  
111.02 SQ.MT. / 1195 SQ.FT.



Unit Plan

Tower D1  
2 BHK  
1260 SQ.FT.

- CARPET AREA :  
75.31 SQ.MT. / 810.64 SQ.FT.
- BALCONY AREA :  
18.65 SQ.MT. / 200.75 SQ.FT.
- COVERED AREA :  
91.53 SQ.MT. / 985.23 SQ.FT.
- SUPER AREA :  
117.05 SQ.MT. / 1260 SQ.FT.



Unit Plan

Tower D1  
2 BHK  
1195 SQ.FT.

- CARPET AREA :  
67.35 SQ.MT. / 724.95 SQ.FT.
- BALCONY AREA :  
21.60 SQ.MT. / 232.50 SQ.FT.
- COVERED AREA :  
86.84 SQ.MT. / 934.74 SQ.FT.
- SUPER AREA :  
111.02 SQ.MT. / 1195 SQ.FT.



# Specifications

## STRUCTURE

RCC framed structure fill within brick walls

## COMMON AREA

- Lift Façade: Pattern cladding in Indian Marble / Tiles or similar.
- Staircases: Flooring in Tile / Granite treads and riser with MS railing or similar.

## EXTERNAL FACADE

Weather-proof paint finish / texture work.

## DOOR AND WINDOWS

- All Wooden doors Chaukhats in Hardwood
- Main entrance door - Wooden Laminated Flush door with door fittings.
- Internal Doors - Laminated Flush doors / Moulded Panel Doors with enamel paints with door fittings.
- Balcony Door / Window- UPVC framed doors and windows with clear glass.

## ELECTRICAL

- Concealed copper wiring in PVC conduits.
- Modular switches, TV and Telephone wiring.

## SECURITY SYSTEM

- Intercom
- CCTV Cameras

## LIVING AND DINING

- Flooring of Tiles.
- Acrylic emulsion paint on wall and ceiling

## BEDROOMS

- Flooring of Tiles.
- Acrylic emulsion paint on wall and ceilings

## KITCHEN

- Granite / Marble counter or similar
- Stainless steel sink
- Tiles up to 2' ft. height above counter
- Anti-skid tiles.
- Acrylic emulsion paint

## BATHROOM

- Anti-skid tiles
- Quality chinaware and CP fittings
- Tiles up to False Ceiling height
- Acrylic emulsion paint on ceiling

## BALCONIES

- Anti-skid tiles
- Weather proof paint finish
- M.S. railing with enamel paint

Omega Club House



Green Park Apartments



Green Park Villa



Green Park Plots



Omega Shopping Center



Orchid Heights Apartments



Events



OMEGA

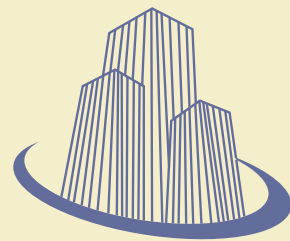

## Setting benchmarks – Delivery, Quality and Value for money

*The impact on life is all-encompassing, be it the comfort of a home, recreation and shopping options in a residential complex or options in the vicinity to learn and grow. We at Omega Developer have a constant quest and an abiding commitment to ensure that the relationship and the lives feel truly enriched – enhanced by understanding what a discerning lifestyle demands. Enhancing quality living is our constant endeavor. We envision our every project and each minute detail in it – we are committed to ensure that the overall experience is rewarding.*

*Lucknow, capital of Uttar Pradesh, has been growing consistently in all the geographical directions. The city is witnessing a dramatic and paradigm shift in its equilibrium from the Central part towards the suburbs. Faizabad Road, on which Omega Green Park Township is situated, is one of the locations most preferred by all classes of people. It is in this backdrop that Omega Developer took its roots, over 6 years with a view to redefine living. Innovation in our offerings combined with an emphasis on value for money options for all classes of people, strong project execution and quality construction have helped us transform into a brand to reckon with. Today, Omega Developer in realty sector has become synonymous to quality, modernity, comfort and convenience, timely delivery and most of all value for money investment options.*



OMEGA  
**Windsor Greens**  
Premium Living. Green Environs.



## OMEGA DEVELOPER AND BUILDERS

Khasra No.174, Opp.Ram Swarup Engineering College, Village Uttardhauna, Lucknow

Cell: +91-8173002400, 8173002409 | [info@omegadeveloper.com](mailto:info@omegadeveloper.com)

[www.omegadeveloper.com](http://www.omegadeveloper.com)

UP Rera Registration No.: UPRERAPRJ17311 | Website: [www.up-rera.in](http://www.up-rera.in)

---

### DISCLAIMER:

Images/Facilities shown above are only representational and informative. Information, images, and visuals are only indicative of the envisaged developments and the same are subject to change in actual as per approvals. The views shown in the pictures may vary over the period of time and does not guarantee the same. All intending purchaser/s are bound to inspect all plans and approvals and visit the project site and apprise themselves of all plans and approvals and other relevant information obtained from time to time from respective authority. The promoter holds no responsibility for its accuracy and shall not be liable to any intending purchaser or anyone for the changes/ alterations/ improvements so made.

The visual representation shown in this brochure is purely conceptual and not a legal offering. All images, plans, specifications, site plan, layout plans etc are tentative and subject to variation and modification by the firm or the competent authorities sanctioning plans.